



RooSy hinged door system manual and automatic

Inhalt

1. General technical data hinged door
2. Details stainless steel door frame
3. Details door leaf
4. Details door window (optional)
5. Manual hinged door
6. Automatic hinged door
7. Drive hinged door





RooSy hinged door system

manual and automatic

General technical data hinged door

Version	Single door	Double door
Grid width	800-1.300 mm	1.500-2.000 mm
Frame height	2.150 mm	2.150 mm
Frame depth	100-600 mm	100-600 mm
Drive system	Manual / DFT 127 (Record) / according to customer requirements	Manual / DFT 127 (Record) / according to customer requirements
Bottom seal (optional)	Lowerable sealing	Lowerable sealing
Radiation protection	0,5-3,5 mm Pb	0,5-3,5 mm Pb
Frame	V2A sanded	V2A sanded
Door leaf	V2A sanded/ V2A powder coated/ HPL	V2A sanded / V2A powder coated / HPL
Door-leaf filling	Foam core XPS	Foam core XPS
manual	Authorities lock KL4 + Door handle– and button sets	Authorities lock KL4 + Door handle– and button sets + Locking rod
automatic	Door knob	Door knob
Door hinge	Approved until 300kg 2 or 3 pieces per door	Approved until 300kg 2 or 3 pieces per door
Opening	Optionally left- or right-opening	Optionally left- or right-opening
Colour	Optional according to colour chart, individual design print possible	Optional according to colour chart, individual design print possible



RooSy hinged door system

manual and automatic

Details stainless steel door frame

Material properties and frame equipment:

Illustrations of the frame variants

- A. Surrounding frame for modular walls with wall connection
- B. Surrounding frame for drywall/masonry with wall connection
- C. Flexible frame for modular wall / drywall / masonry etc.

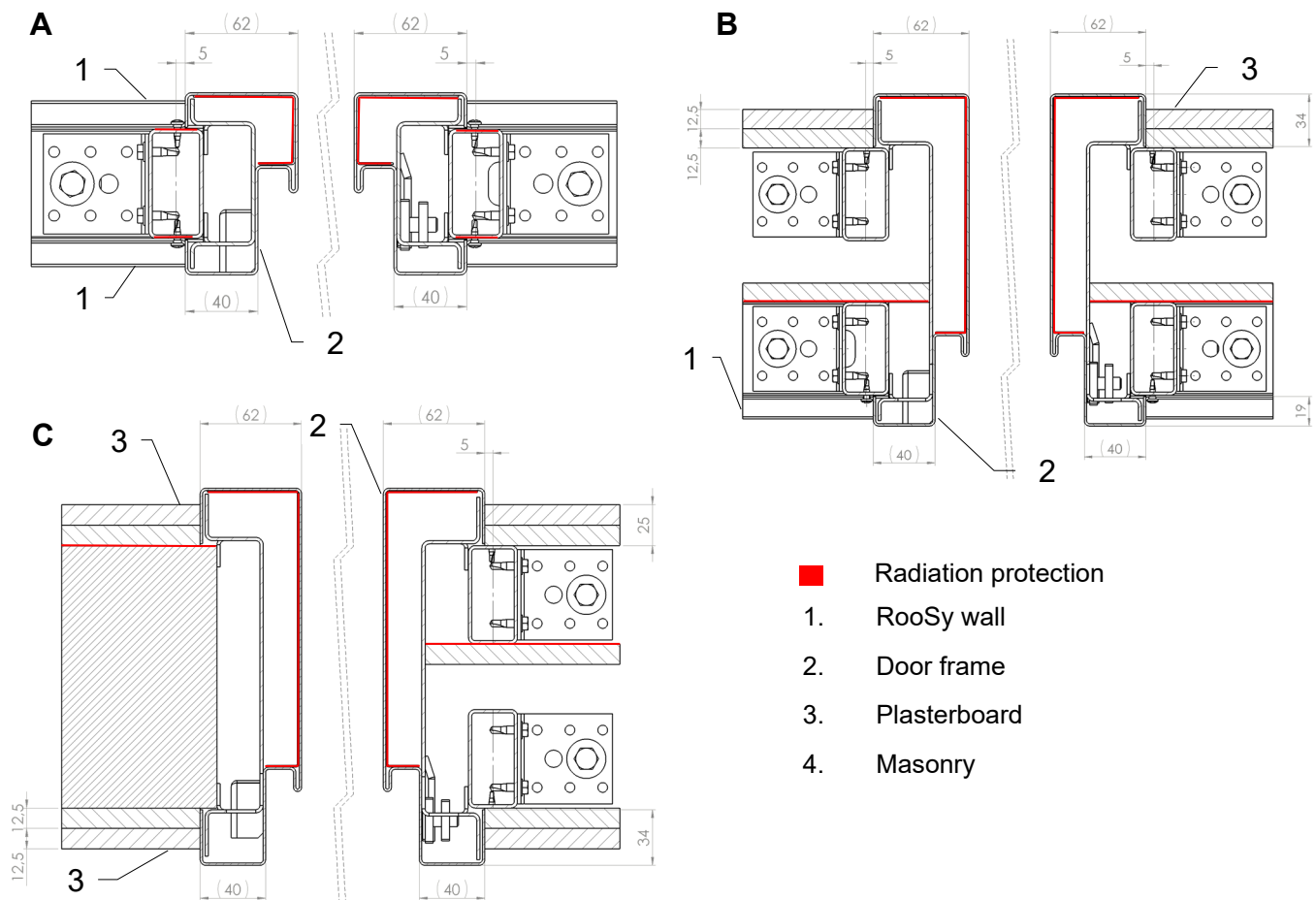



RooSy hinged door system

manual and automatic

Details door leaf

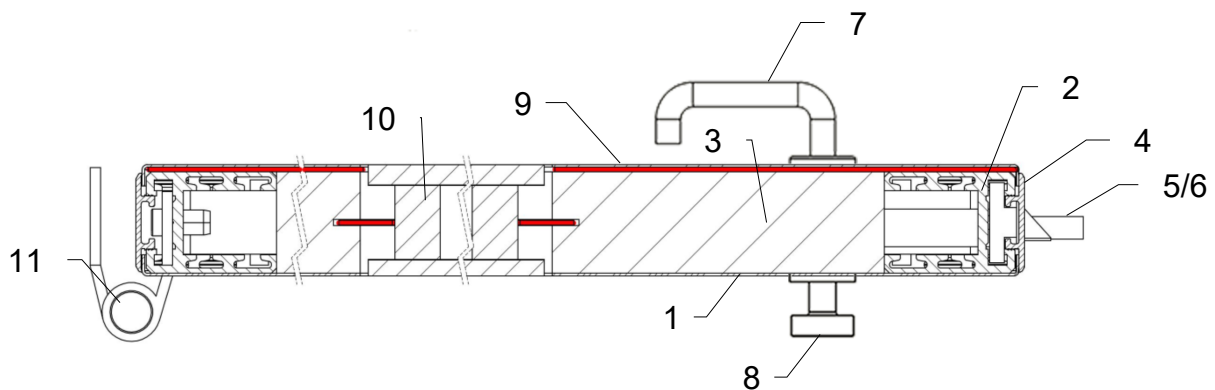

1. 1mm stainless steel sheet either powder-coated or sanded → Correspond to the fire protection class A2
2. Aluminium frame encircling
3. Door-leaf filling foam core XPS or tubular chip board → Correspond to the fire protection class B2
4. Cover aluminium profile encircling
5. Authorities lock KL4
6. Radiation protection lock from 2 mm Pb
7. Door handle – and button sets door leaf manual
8. Door knob door leaf automatic
9. Lead protection up to 3,5 mm Pb

Pb	1,0 Pb	2,0 Pb	3,0 Pb	without
Thickness door	41 mm	42 mm	43 mm	40 mm

10. Flush integrated door window
11. Hinge



RooSy hinged door system

manual and automatic

Details door window

- 2x ESG glass with pressure compensation glued together
- Also possible in combination with radiation protection
- Insulating glass is flush glued with door leaf
- Optional with electric blind

Dimensions	450x600 mm	600x600 mm	800x600 mm	450x1.500 mm
Blinds	✓	✓	✓	✓
Laser blinds	✓	✓	✓	✓
Radiation protection	Up to 3,5 mm	Up to 3,5 mm	Up to 3,5 mm	Up to 2 mm





RooSy hinged door system

manual and automatic

Buttons and switches

For the RooSy hinged door system, there are different variants of buttons and switches for opening the electric door.

Clean Switch: Touchless switch for convenient activation of accesses with high hygiene and design requirements. Various pictograms can be selected.

Piktogramme
Aufdruck auf Cover

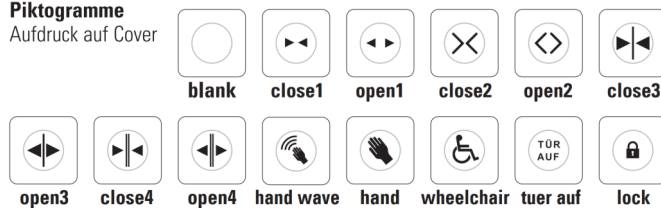

Jung Button:

Button in stainless steel design for operating the hinged door.



Optionally also possible according to customer requirements, e.g. with safety edge.



RooSy hinged door system

manual and automatic

Hinged door manual

Hinged door one leaf manual

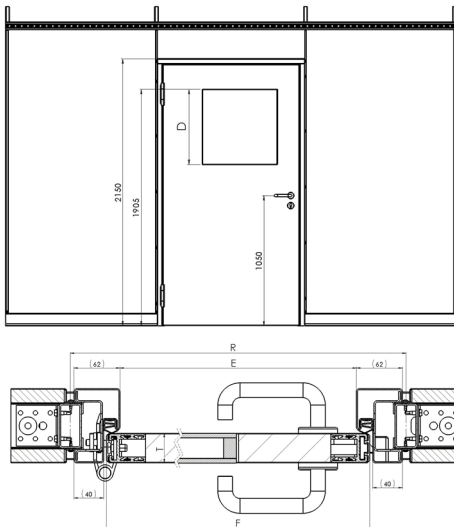

R (grid)	E (intake clearance)	F (wide door leaf)
800	666	702
900	766	802
1.000	866	902
1.100	966	1.002
1.200	1.066	1.102
1.300	1.166	1.202

Hinged door two leaf manual

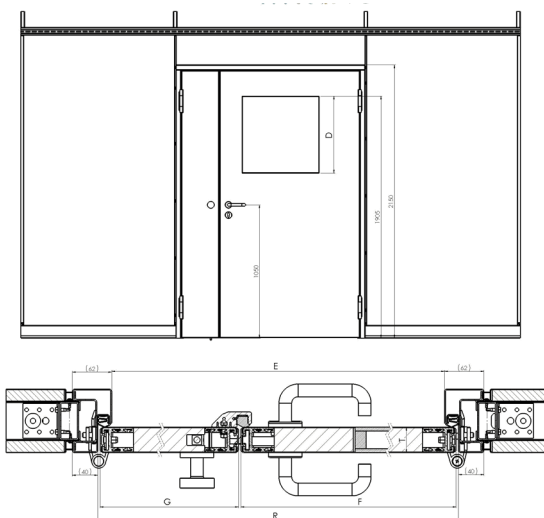

R (Grid)	E (intake clearance)	G (wide door stand-)	F (wide door leaf)
1.500	1.366	296	1.102
1.600	1.466	296	1.202
1.700	1.566	496	1.102
1.800	1.666	496	1.202
1.900	1.766	696	1.102
2.000	1.866	696	1.202



RooSy hinged door system

manual and automatic

Hinged door automatic

Hinged door one leaf automatic

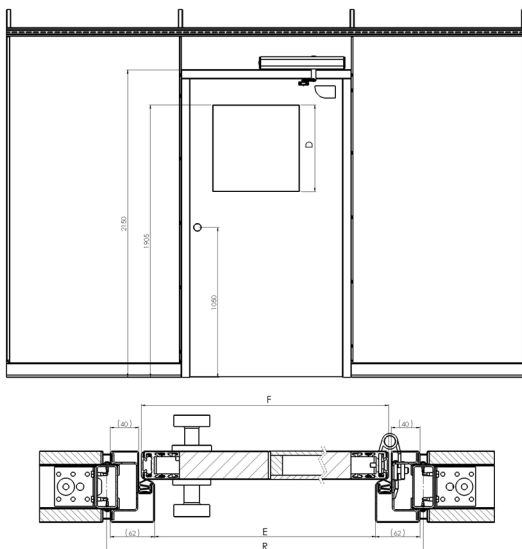

R (grid)	E (intake clearance)	F (wide door leaf)
800	666	702
900	766	802
1000	866	902
1.100	966	1.002
1.200	1.066	1.102
1.300	1.166	1.202

Hinged door two leaf automatic

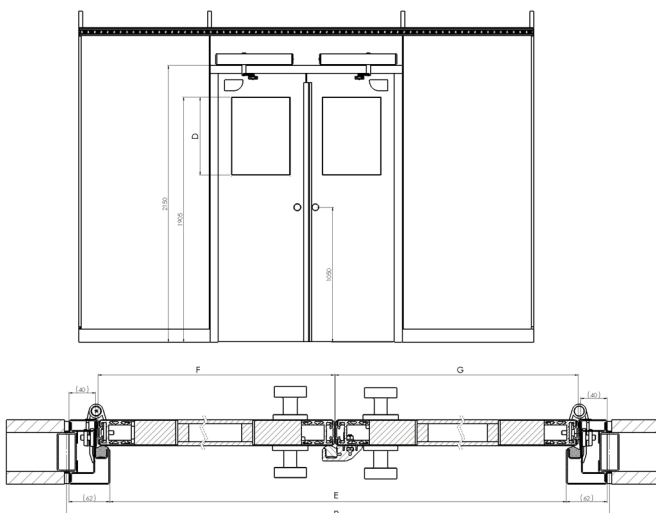

R (Grid)	E (intake clearance)	G (wide door standleaf)	F (wide door leaf)
1.500	1.366	699	699
1.600	1.466	749	749
1.700	1.566	799	799
1.800	1.666	849	849
1.900	1.766	899	899
2.000	1.866	949	949



RooSy hinged door system manual and automatic

Drive system hinged door

- Manual
- Automatisch Record DFA 127
- According to customer requirements

Certificated to:

- DIN 18650-1/-2 ;2005
- DIN 18650-1/-2;2010
- DIN EN 16005:2013
- DIN EN ISO 13849-1:2008 in combination with DIN EN 16005:2013
- CE– entification according to EMV-guideline

Properties:

- Strong sloping opening moment during manual inspection
- Control with connectible tip automatic
- With locally infinitely variable adjustable spring force for door closer sizes EN4– EN6
- Program switch for automatic– continuously open– and manual operation optional integrated in side cover
- Electrical supply data: 230VAC, 50/60Hz, 67W rated output (only about 13W in retirement mode)
- Dimensions: 85x125x600 (HxDxW)

Standard functions and configuration options:

- Automatic reversing mechanism, force limitation in open- and closing direction
- Automatic teach-in-test run for the adjusted spring force, the door parameter and the sensors (connected via CAN Bus)
- Opening time infinitely variable 3-20sec. ,closing time infinitely variable 5-20sec.
- Opening angle infinitely variable 70-115°
- Power Assist as a motoric opening aid for manuel moving a heavy door with little effort
- Electrical closing sequence regulator for 2 leaf door systems
- Low Energy Modus in accordance with DIN18650 and EN 16005
- Controlling on-site electric door strikes,
- Connection for an emergency stop button is available
- Connections for conventional sensors and switches are available



RooSy hinged door system manual and automatic

Drive system hinged door

Options for drive system:

- Standard rod pressing, recess depth to 330mm
- Sliding rails arm pulling
- Sliding rails arm pushing

Pulse generator:

- Standard pushbutton (Jung Switch program)
- Large sized pushbutton
- CleanSwitch (Contactless button)
- Wireless pushbutton
- RAD290 Radar—motion sensor

Fuse protection:

- Laser scanner with time-of-flight-measurement incl. fuse protection of the secondary closing edge
- with DIN18650 and EN 16005
- Infrared sensor bar

Options:

- Cabel transition flexible
- Adjustable position switch
- Integral electromagnetic brake
- Execution as a invers-propulsion (automatic, hinged door propulsion with currentless opening in the event of a power failure)
- Lock control